

FRANKE'S

Multi-use (janitorial, pet care, etc.) Utility Sinks



Franke
buys
American
steel



Eivers/#43_01|2019

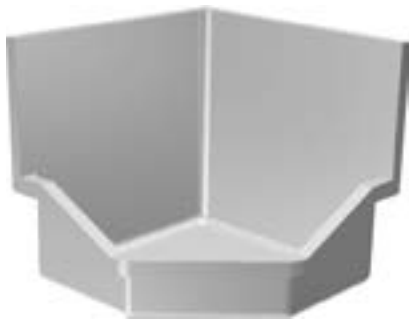

MSRP: \$6,617.00
FSS02210/316-1
Install Left or Right

16 gauge (1.5 mm), type 316 (EN1.4401 17/12/2) stainless steel. Polished #4 satin finish. Radius coved bowl corners. Undercoated to reduce condensation and resonance. One piece wall hangers. Comes with integral back splash and side splash. Includes 2" IPS grid center shower drain. Certified to ASME A112.19.3-2008 / CSA B45.4-08. Please allow 4 weeks for delivery.

24 x 24" Overall (square) 24 x 36" Overall (rectangular)

APPLICATIONS:

- JANITORIAL
- PET CARE
- SERVICE SINKS



FOR CUSTOMER SERVICE, CONTACT
1-855-526-0503 (USA)
commercial-info.us@franke.com (USA)
www.franke-commercial.com



MSRP: \$5,766.00
FSSR223410/316-1
Install Right and Rear



MSRP: \$5,766.00
FSSL223410/316-1
Install Left and Rear



MSRP: \$6,787.00
FSSOL223410/316-1
Install Left and Rear



MSRP: \$6,787.00
FSSOR223410/316-1
Install Right and Rear



MSRP: \$4,512.00
FSS222210/316-1
Install Left or Right



MSRP: \$6,617.00
FSS2210/316-1
Install Left or Right

