



BOUTIQUE
COLLECTION

Net Pricing
JULY 2017 TO DECEMBER 31, 2017

Zone 9
Net prices include freight.
Multiplier does not apply.



BOUTIQUE COLLECTION® Standard Lead Time
Counter Sinks, Vanity Counter Tops and Benches • 15 - 20 business days

Please contact order entry department at
800-783-8827 or orderentry@mtibaths.com for availability.

BOUTIQUE COLLECTION Single Bowl Counter-Sinks

PETRA COUNTER-SINK 1			
model #MTCS-801 • bowl size: 15.875" (l) x 14" (d)			
Length	Finish	Part #	Net Price
up to 38"	Matte	C801-S38MT	\$662
	Gloss	C801-S38GL	\$825
up to 50"	Matte	C801-S50MT	\$997
	Gloss	C801-S50GL	\$1,196
up to 62"	Matte	C801-S62MT	\$1,099
	Gloss	C801-S62GL	\$1,342
up to 74"	Matte	C801-S74MT	\$1,222
	Gloss	C801-S74GL	\$1,488
up to 86"	Matte	C801-S86MT	\$1,472
	Gloss	C801-S86GL	\$1,738

PETRA COUNTER-SINK 2			
model #MTCS-802 • bowl size: 15" (l) x 10.5" (d)			
Length	Finish	Part #	Net Price
up to 38"	Matte	C802-S38MT	\$662
	Gloss	C802-S38GL	\$825
up to 50"	Matte	C802-S50MT	\$997
	Gloss	C802-S50GL	\$1,196
up to 62"	Matte	C802-S62MT	\$1,099
	Gloss	C802-S62GL	\$1,342
up to 74"	Matte	C802-S74MT	\$1,222
	Gloss	C802-S74GL	\$1,488
up to 86"	Matte	C802-S86MT	\$1,472
	Gloss	C802-S86GL	\$1,738

PETRA COUNTER-SINK 3			
model #MTCS-803 • bowl size: 17.5" (l) x 11.5" (d)			
Length	Finish	Part #	Net Price
up to 38"	Matte	C803-S38MT	\$662
	Gloss	C803-S38GL	\$825
up to 50"	Matte	C803-S50MT	\$997
	Gloss	C803-S50GL	\$1,196
up to 62"	Matte	C803-S62MT	\$1,099
	Gloss	C803-S62GL	\$1,342
up to 74"	Matte	C803-S74MT	\$1,222
	Gloss	C803-S74GL	\$1,488
up to 86"	Matte	C803-S86MT	\$1,472
	Gloss	C803-S86GL	\$1,738

Net pricing includes freight, multiplier does not apply.

Prices are based on a deck height of 1/2".
Heights above 1/2" are an upcharge.

PETRA COUNTER-SINK 4			
model #MTCS-804 • bowl size: 20.25" (l) x 12.625" (d)			
Length	Finish	Part #	Net Price
up to 38"	Matte	C804-S38MT	\$675
	Gloss	C804-S38GL	\$841
up to 50"	Matte	C804-S50MT	\$1,015
	Gloss	C804-S50GL	\$1,207
up to 62"	Matte	C804-S62MT	\$1,124
	Gloss	C804-S62GL	\$1,353
up to 74"	Matte	C804-S74MT	\$1,234
	Gloss	C804-S74GL	\$1,504
up to 86"	Matte	C804-S86MT	\$1,484
	Gloss	C804-S86GL	\$1,754

PETRA COUNTER-SINK 5 (single drain trough)			
model #MTCS-805 • bowl size: 46.25" (l) x 12.375" (d)			
Length	Finish	Part #	Net Price
up to 62"	Matte	C805-S62MT	\$1,299
	Gloss	C805-S62GL	\$1,542
up to 74"	Matte	C805-S74MT	\$1,417
	Gloss	C805-S74GL	\$1,704
up to 86"	Matte	C805-S86MT	\$1,667
	Gloss	C805-S86GL	\$1,954

PETRA COUNTER-SINK 6 (dual drain trough)			
model #MTCS-806 • bowl size: 46.25" (l) x 12.375" (d)			
Length	Finish	Part #	Net Price
up to 62"	Matte	C806-S62MT	\$1,299
	Gloss	C806-S62GL	\$1,542
up to 74"	Matte	C806-S74MT	\$1,417
	Gloss	C806-S74GL	\$1,704
up to 86"	Matte	C806-S86MT	\$1,667
	Gloss	C806-S86GL	\$1,954

PETRA COUNTER-SINK 7 (single drain trough)			
model #MTCS-807 • bowl size: 39.5" (l) x 12.625" (d)			
Length	Finish	Part #	Net Price
up to 50"	Matte	C807-S50MT	\$1,063
	Gloss	C807-S50GL	\$1,261
up to 62"	Matte	C807-S62MT	\$1,175
	Gloss	C807-S62GL	\$1,423
up to 74"	Matte	C807-S74MT	\$1,297
	Gloss	C807-S74GL	\$1,553
up to 86"	Matte	C807-S86MT	\$1,547
	Gloss	C807-S86GL	\$1,803

BOUTIQUE COLLECTION Single Bowl Counter-Sinks

PETRA COUNTER-SINK 8 (dual drain trough) model #MTCS-808 ◦ bowl size: 39.5" (l) x 12.625" (d)			
Length	Finish	Part #	Net Price
up to 50"	Matte	C808-S50MT	\$1,063
	Gloss	C808-S50GL	\$1,261
up to 62"	Matte	C808-S62MT	\$1,175
	Gloss	C808-S62GL	\$1,423
up to 74"	Matte	C808-S74MT	\$1,297
	Gloss	C808-S74GL	\$1,553
up to 86"	Matte	C808-S86MT	\$1,547
	Gloss	C808-S86GL	\$1,803
PETRA COUNTER-SINK 9 model #MTCS-809 ◦ bowl size: 13" (l) x 8" (d)			
Length	Finish	Part #	Net Price
up to 38"	Matte	C809-S38MT	\$662
	Gloss	C809-S38GL	\$825
up to 50"	Matte	C809-S50MT	\$997
	Gloss	C809-S50GL	\$1,196
up to 62"	Matte	C809-S62MT	\$1,099
	Gloss	C809-S62GL	\$1,342
up to 74"	Matte	C809-S74MT	\$1,222
	Gloss	C809-S74GL	\$1,488
up to 86"	Matte	C809-S86MT	\$1,472
	Gloss	C809-S86GL	\$1,738
PETRA COUNTER-SINK 10 (single drain trough) model #MTCS-810 ◦ bowl size: 52" (l) x 12.625" (d)			
Length	Finish	Part #	Net Price
up to 62"	Matte	C810-S62MT	\$1,324
	Gloss	C810-S62GL	\$1,567
up to 74"	Matte	C810-S74MT	\$1,442
	Gloss	C810-S74GL	\$1,729
up to 86"	Matte	C810-S86MT	\$1,692
	Gloss	C810-S86GL	\$1,979
PETRA COUNTER-SINK 12 (single drain trough) model #MTCS-812 ◦ bowl size: 64" (l) x 12.625" (d)			
Length	Finish	Part #	Net Price
up to 74"	Matte	C812-S74MT	\$1,492
	Gloss	C812-S74GL	\$1,779
up to 86"	Matte	C812-S86MT	\$1,742
	Gloss	C812-S86GL	\$2,029

WYMARA COUNTER-SINK 1 model #MTCS-821 ◦ bowl size: 17.75" (l) x 13.75" (d)			
Length	Finish	Part #	Net Price
up to 38"	Matte	C821-S38MT	\$765
	Gloss	C821-S38GL	\$923
up to 50"	Matte	C821-S50MT	\$1,099
	Gloss	C821-S50GL	\$1,295
up to 62"	Matte	C821-S62MT	\$1,207
	Gloss	C821-S62GL	\$1,436
up to 74"	Matte	C821-S74MT	\$1,315
	Gloss	C821-S74GL	\$1,585
up to 86"	Matte	C821-S86MT	\$1,565
	Gloss	C821-S86GL	\$1,835
WYMARA COUNTER-SINK 2 model #MTCS-822 ◦ bowl size: 33.25" (l) x 13.5" (d)			
Length	Finish	Part #	Net Price
up to 50"	Matte	C822-S50MT	\$1,129
	Gloss	C822-S50GL	\$1,337
up to 62"	Matte	C822-S62MT	\$1,238
	Gloss	C822-S62GL	\$1,467
up to 74"	Matte	C822-S74MT	\$1,347
	Gloss	C822-S74GL	\$1,617
up to 86"	Matte	C822-S86MT	\$1,597
	Gloss	C822-S86GL	\$1,867
ALISSA COUNTER-SINK model #MTCS-841 ◦ bowl size: 18.625" (l) x 12.875" (d)			
Length	Finish	Part #	Net Price
up to 38"	Matte	C841-S38MT	\$662
	Gloss	C841-S38GL	\$825
up to 50"	Matte	C841-S50MT	\$997
	Gloss	C841-S50GL	\$1,196
up to 62"	Matte	C841-S62MT	\$1,099
	Gloss	C841-S62GL	\$1,342
up to 74"	Matte	C841-S74MT	\$1,222
	Gloss	C841-S74GL	\$1,488
up to 86"	Matte	C841-S86MT	\$1,472
	Gloss	C841-S86GL	\$1,738

Net pricing includes freight, multiplier does not apply.

Prices are based on a deck height of 1/2".
Heights above 1/2" are an upcharge.

BOUTIQUE COLLECTION Single Bowl Counter-Sinks

HALO COUNTER-SINK 1			
model #MTCS-861 • bowl size: 14.25" (d)			
Length	Finish	Part #	Net Price
up to 38"	Matte	C861-S38MT	\$662
	Gloss	C861-S38GL	\$825
up to 50"	Matte	C861-S50MT	\$997
	Gloss	C861-S50GL	\$1,196
up to 62"	Matte	C861-S62MT	\$1,099
	Gloss	C861-S62GL	\$1,342
up to 74"	Matte	C861-S74MT	\$1,222
	Gloss	C861-S74GL	\$1,488
up to 86"	Matte	C861-S86MT	\$1,472
	Gloss	C861-S86GL	\$1,738

HALO COUNTER-SINK 2			
model #MTCS-863 • bowl size: 17" (d)			
Length	Finish	Part #	Net Price
up to 38"	Matte	C863-S38MT	\$662
	Gloss	C863-S38GL	\$825
up to 50"	Matte	C863-S50MT	\$997
	Gloss	C863-S50GL	\$1,196
up to 62"	Matte	C863-S62MT	\$1,099
	Gloss	C863-S62GL	\$1,342
up to 74"	Matte	C863-S74MT	\$1,222
	Gloss	C863-S74GL	\$1,488
up to 86"	Matte	C863-S86MT	\$1,472
	Gloss	C863-S86GL	\$1,738

INCLINE COUNTER-SINK			
model #MTCS-866 • bowl size: 19" (l) x 15" (d)			
Length	Finish	Part #	Net Price
up to 38"	Matte	C866-S38MT	\$800
	Gloss	C866-S38GL	\$958
up to 50"	Matte	C866-S50MT	\$1,134
	Gloss	C866-S50GL	\$1,330
up to 62"	Matte	C866-S62MT	\$1,242
	Gloss	C866-S62GL	\$1,471
up to 74"	Matte	C866-S74MT	\$1,350
	Gloss	C866-S74GL	\$1,620
up to 86"	Matte	C866-S86MT	\$1,600
	Gloss	C866-S86GL	\$1,870

Net pricing includes freight, multiplier does not apply.

Prices are based on a deck height of 1/2".
Heights above 1/2" are an upcharge.

LUNA COUNTER-SINK 1			
model #MTCS-864 • bowl size: 13" (d)			
Length	Finish	Part #	Net Price
up to 38"	Matte	C864-S38MT	\$662
	Gloss	C864-S38GL	\$825
up to 50"	Matte	C864-S50MT	\$997
	Gloss	C864-S50GL	\$1,196
up to 62"	Matte	C864-S62MT	\$1,099
	Gloss	C864-S62GL	\$1,342
up to 74"	Matte	C864-S74MT	\$1,222
	Gloss	C864-S74GL	\$1,488
up to 86"	Matte	C864-S86MT	\$1,472
	Gloss	C864-S86GL	\$1,738

LUNA COUNTER-SINK 2			
model #MTCS-865 • bowl size: 15" (d)			
Length	Finish	Part #	Net Price
up to 38"	Matte	C865-S38MT	\$662
	Gloss	C865-S38GL	\$825
up to 50"	Matte	C865-S50MT	\$997
	Gloss	C865-S50GL	\$1,196
up to 62"	Matte	C865-S62MT	\$1,099
	Gloss	C865-S62GL	\$1,342
up to 74"	Matte	C865-S74MT	\$1,222
	Gloss	C865-S74GL	\$1,488
up to 86"	Matte	C865-S86MT	\$1,472
	Gloss	C865-S86GL	\$1,738

NOTE:

See individual worksheet & order form in the MTI binder or mtibaths.com.

Prices listed should be entered next to the appropriate part # on the form.

Submit a signed & completed worksheet with the purchase order.

Submit a copy of the vanity specifications with order to ensure proper fit & finish of Counter-Sink.

Carefully review inside of vanity spec's to ensure the proper clearance to accommodate the bowl, drain and optional integrated overflow (if applicable).

Take into consideration thickness of material under the countertop, when positioning sink bowl, using a deck-mounted faucet or adding optional integrated overflow.

Optional 'carrier arms' are recommended for wall-mount installation.

BOUTIQUE COLLECTION Single Bowl Options

SINK OPTIONS	PART #	NET PRICE
Deck Height ◦ Standard height is 1/2"		
> 1/2" up to 3"	CDH2	\$120
> 3" up to 6"	CDH3	\$240
Integrated Overflow		
Front installation for single drain bowls	CIOF	\$75
Back installation for single drain bowls	CIOB	\$75
Front installation for double drain bowls	CIOF2	\$150
Back installation for double drain bowls	CIOB2	\$150
Faucet Holes ◦ up to 3 holes drilled for single drain or 6 for double drains		
up to 3 single drain	CFH	\$25
up to 6 double drain	CFH	\$25
Backsplash ◦ 4" (h) height x 5/8" thick		
Length up to 50"	CBSM	\$100
Length 51" up to 86"	CBLG	\$135
Sidesplash ◦ 4" (h) height x 5/8" thick		
Left	CSL	\$60
Right	CSR	\$60
Edge Treatment		
Cove	CET1	\$45
Roundover	CET2	\$45
Roman Ogee	CET3	\$45
Carrier Arms for wall mounting		
Two	CCA2	\$160
Three	CCA3	\$230
Sink Bottom Covers (see worksheet for proper size)		
Small, matte finish	CBCSMT	\$173
small, gloss finish	CBCSGL	\$204
Large, matte finish	CBCLMT	\$275
Large, gloss finish	CBCLGL	\$326
X-Large, matte finish	CBCXLMT	\$340
X-Large, gloss finish	CBCXLGL	\$400
Special Color: Enter specific color code from below	CBCCOLG	\$75
	CBCCOLM	\$75
colors: OX = Onyx NF = Nightfall SG = Stormgray MS = Moonstone BL = Blue Lagoon TC = Terracotta		
Teak Sink Tray		
For toiletries & accessories	CTKST	\$56

Net pricing includes freight, multiplier does not apply.

Prices are based on a deck height of 1/2".
Heights above 1/2" are an upcharge.

EDGE TREATMENTS

If gloss finish is selected, it will only apply to the sink bowl, top and vertical surface of the Counter-Sink.

The detail area will remain in a matte finish as denoted by the (*) in the diagrams below.

A 1" minimum counter thickness is required for edge treatments.

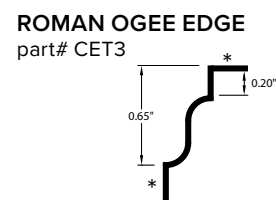
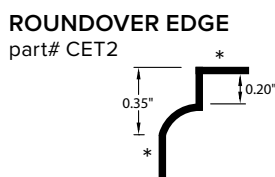
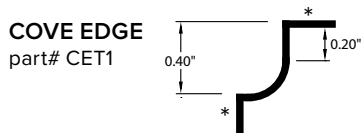

DRAIN KITS

DRAIN	FINISH	PART #	PRICE/EA.
Finger Touch Drain ◦ Fully plated brass drain body & tailpiece. Features round flip drain that opens and closes.			
With Overflow	Chrome	CFGC	\$45
	Brushed Nickel	CFGBN	\$50
Without Overflow	Chrome	CFGCN	\$45
	Brushed Nickel	CFGBNN	\$50
Fixed Drain ◦ Dome-style drain for sinks without an overflow. Fully plated brass drain body and tailpiece.			
Without Overflow	Chrome	CFDC	\$80
Grid Drain ◦ Decorative, fully plated, 20-hole brass grid drain. Features 'fast flow angle top', with no clogging or puddling of water.			
With Overflow	Chrome	CGDC	\$30
	Brushed Nickel	CGDCBN	\$45
Without Overflow	Chrome	CGDCN	\$30
	Brushed Nickel	CGDCBNN	\$45

BOUTIQUE COLLECTION Double Bowl Counter-Sinks

PETRA COUNTER-SINK 1			
model #MTCS-801 • bowl size: 15.875" (l) x 14" (d)			
Length	Finish	Part #	Net Price
up to 50"	Matte	C801-D50MT	\$1,115
	Gloss	C801-D50GL	\$1,326
up to 62"	Matte	C801-D62MT	\$1,283
	Gloss	C801-D62GL	\$1,467
up to 74"	Matte	C801-D74MT	\$1,341
	Gloss	C801-D74GL	\$1,617
up to 86"	Matte	C801-D86MT	\$1,591
	Gloss	C801-D86GL	\$1,867

PETRA COUNTER-SINK 3			
model #MTCS-802 • bowl size: 15" (l) x 10.5" (d)			
Length	Finish	Part #	Net Price
up to 50"	Matte	C802-D50MT	\$1,115
	Gloss	C802-D50GL	\$1,326
up to 62"	Matte	C802-D62MT	\$1,283
	Gloss	C802-D62GL	\$1,467
up to 74"	Matte	C802-D74MT	\$1,341
	Gloss	C802-D74GL	\$1,617
up to 86"	Matte	C802-D86MT	\$1,591
	Gloss	C802-D86GL	\$1,867

PETRA COUNTER-SINK 3			
model #MTCS-803 • bowl size: 17.5" (l) x 11.5" (d)			
Length	Finish	Part #	Net Price
up to 50"	Matte	C803-D50MT	\$1,115
	Gloss	C803-D50GL	\$1,326
up to 62"	Matte	C803-D62MT	\$1,283
	Gloss	C803-D62GL	\$1,467
up to 74"	Matte	C803-D74MT	\$1,341
	Gloss	C803-D74GL	\$1,617
up to 86"	Matte	C803-D86MT	\$1,591
	Gloss	C803-D86GL	\$1,867

PETRA COUNTER-SINK 4			
model #MTCS-804 • bowl size: 20.25" (l) x 12.625" (d)			
Length	Finish	Part #	Net Price
up to 62"	Matte	C804-D62MT	\$1,320
	Gloss	C804-D62GL	\$1,564
up to 74"	Matte	C804-D74MT	\$1,428
	Gloss	C804-D74GL	\$1,715
up to 86"	Matte	C804-D86MT	\$1,678
	Gloss	C804-D86GL	\$1,965

PETRA COUNTER-SINK 9			
model #MTCS-809 • bowl size: 13" (l) x 8" (d)			
Length	Finish	Part #	Net Price
up to 50"	Matte	C809-D50MT	\$1,115
	Gloss	C809-D50GL	\$1,326
up to 62"	Matte	C809-D62MT	\$1,283
	Gloss	C809-D62GL	\$1,467
up to 74"	Matte	C809-D74MT	\$1,341
	Gloss	C809-D74GL	\$1,617
up to 86"	Matte	C809-D86MT	\$1,591
	Gloss	C809-D86GL	\$1,867

WYMARÁ COUNTER-SINK 1			
model #MTCS-821 • bowl size: 17.75" (l) x 13.75" (d)			
Length	Finish	Part #	Net Price
up to 50"	Matte	C821-D50MT	\$1,312
	Gloss	C821-D50GL	\$1,523
up to 62"	Matte	C821-D62MT	\$1,421
	Gloss	C821-D62GL	\$1,667
up to 74"	Matte	C821-D74MT	\$1,531
	Gloss	C821-D74GL	\$1,812
up to 86"	Matte	C821-D86MT	\$1,781
	Gloss	C821-D86GL	\$2,062

ALISSA COUNTER-SINK			
model #MTCS-841 • bowl size: 18.625" (l) x 12.875" (d)			
Length	Finish	Part #	Net Price
up to 50"	Matte	C841-D50MT	\$1,115
	Gloss	C841-D50GL	\$1,326
up to 62"	Matte	C841-D62MT	\$1,283
	Gloss	C841-D62GL	\$1,467
up to 74"	Matte	C841-D74MT	\$1,341
	Gloss	C841-D74GL	\$1,617
up to 86"	Matte	C841-D86MT	\$1,591
	Gloss	C841-D86GL	\$1,867

Net pricing includes freight, multiplier does not apply.

Prices are based on a deck height of 1/2".
Heights above 1/2" are an upcharge.

BOUTIQUE COLLECTION Double Bowl Counter-Sinks

HALO COUNTER-SINK 1			
model #MTCS-861 • bowl size: 14.25" (d)			
Length	Finish	Part #	Net Price
up to 50"	Matte	C861-D50MT	\$1,115
	Gloss	C861-D50GL	\$1,326
up to 62"	Matte	C861-D62MT	\$1,283
	Gloss	C861-D62GL	\$1,467
up to 74"	Matte	C861-D74MT	\$1,341
	Gloss	C861-D74GL	\$1,617
up to 86"	Matte	C861-D86MT	\$1,591
	Gloss	C861-D86GL	\$1,867

HALO COUNTER-SINK 3			
model #MTCS-863 • bowl size: 17" (d)			
Length	Finish	Part #	Net Price
up to 50"	Matte	C863-D50MT	\$1,115
	Gloss	C863-D50GL	\$1,326
up to 62"	Matte	C863-D62MT	\$1,283
	Gloss	C863-D62GL	\$1,467
up to 74"	Matte	C863-D74MT	\$1,341
	Gloss	C863-D74GL	\$1,617
up to 86"	Matte	C863-D86MT	\$1,591
	Gloss	C863-D86GL	\$1,867

INCLINE COUNTER-SINK			
model #MTCS-866 • bowl size: 19" (l) x 15" (d)			
Length	Finish	Part #	Net Price
up to 50"	Matte	C866-D50MT	\$1,382
	Gloss	C866-D50GL	\$1,593
up to 62"	Matte	C866-D62MT	\$1,491
	Gloss	C866-D62GL	\$1,737
up to 74"	Matte	C866-D74MT	\$1,601
	Gloss	C866-D74GL	\$1,882
up to 86"	Matte	C866-D86MT	\$1,851
	Gloss	C866-D86GL	\$2,132

Net pricing includes freight, multiplier does not apply.

Prices are based on a deck height of 1/2".
Heights above 1/2" are an upcharge.

LUNA COUNTER-SINK 1			
model #MTCS-864 • bowl size: 13" (d)			
Length	Finish	Part #	Net Price
up to 50"	Matte	C864-D50MT	\$1,115
	Gloss	C864-D50GL	\$1,326
up to 62"	Matte	C864-D62MT	\$1,283
	Gloss	C864-D62GL	\$1,467
up to 74"	Matte	C864-D74MT	\$1,341
	Gloss	C864-D74GL	\$1,617
up to 86"	Matte	C864-D86MT	\$1,591
	Gloss	C864-D86GL	\$1,867

LUNA COUNTER-SINK 2			
model #MTCS-865 • bowl size: 15" (d)			
Length	Finish	Part #	Net Price
up to 50"	Matte	C865-D50MT	\$1,115
	Gloss	C865-D50GL	\$1,326
up to 62"	Matte	C865-D62MT	\$1,283
	Gloss	C865-D62GL	\$1,467
up to 74"	Matte	C865-D74MT	\$1,341
	Gloss	C865-D74GL	\$1,617
up to 86"	Matte	C865-D86MT	\$1,591
	Gloss	C865-D86GL	\$1,867

NOTE:

See individual worksheet & order form in the MTI binder or mtibaths.com.

Prices listed should be entered next to the appropriate part # on the form.

Submit a signed & completed worksheet with the purchase order.

Submit a copy of the vanity specifications with order to ensure proper fit & finish of Counter-Sink.

Carefully review inside of vanity soec's to ensure the proper clearance to accommodate the bowl, drain and optional integrated overflow (if applicable).

Take into consideration thickness of material under the countertop, when positioning sink bowl, using a deck-mounted faucet or adding optional integrated overflow.

Optional 'carrier arms' are recommended for wall-mount installation.

BOUTIQUE COLLECTION Double Bowl Options

SINK OPTIONS	PART #	NET PRICE
Deck Height ◦ Standard height is 1/2"		
> 1/2" up to 3"	CDH2	\$120
> 3" up to 6"	CDH3	\$240
Integrated Overflow		
Front installation for double bowls	CIOF2	\$150
Back installation for double bowls	CIOB2	\$150
Faucet Holes ◦ up to 6 for double bowls		
up to 6 double bowls	CFH	\$25
Backsplash ◦ 4" (h) height x 5/8" thick		
Length up to 50"	CBSM	\$100
Length 51" up to 86"	CBLG	\$135
Sidesplash ◦ 4" (h) height x 5/8" thick		
Left	CSL	\$60
Right	CSR	\$60
Edge Treatment		
Cove	CET1	\$45
Roundover	CET2	\$45
Roman Ogee	CET3	\$45
Carrier Arms for wall mounting		
Two	CCA2	\$160
Three	CCA3	\$230
Sink Bottom Covers (see worksheet for proper size)		
Small, matte finish	CBCSMT	\$173
small, gloss finish	CBCSGL	\$204
Large, matte finish	CBCLMT	\$275
Large, gloss finish	CBCLGL	\$326
X-Large, matte finish	CBCXLMT	\$340
X-Large, gloss finish	CBCXLGL	\$400
Special Color: Enter specific color code from below	CBCCOLG	\$75
	CBCCOLM	\$75
colors: OX = Onyx NF = Nightfall SG = Stormgray MS = Moonstone BL = Blue Lagoon TC = Terracotta		
Teak Sink Tray		
For toiletries & accessories	CTKST	\$56

Net pricing includes freight, multiplier does not apply.

Prices are based on a deck height of 1/2".
Heights above 1/2" are an upcharge.

DRAIN KITS

DRAIN	FINISH	PART #	PRICE/EA.
Finger Touch Drain ◦ Fully plated brass drain body & tailpiece. Features round flip drain that opens and closes.			
With Overflow	Chrome	CFG2	\$45
	Brushed Nickel	CFGBN2	\$50
Without Overflow	Chrome	CFG2N	\$45
	Brushed Nickel	CFGBN2N	\$50
Fixed Drain ◦ Dome-style drain for sinks without an overflow. Fully plated brass drain body and tailpiece.			
Without Overflow	Chrome	CFDC2	\$80
Grid Drain ◦ Decorative, fully plated, 20-hole brass grid drain. Features 'fast flow angle top', with no clogging or puddling of water.			
With Overflow	Chrome	CGDC2	\$30
	Brushed Nickel	CGDCBN2	\$45
Without Overflow	Chrome	CGDC2N	\$30
	Brushed Nickel	CGDCBN2N	\$45

EDGE TREATMENTS

If gloss finish is selected, it will only apply to the sink bowl, top and vertical surface of the Counter-Sink.

The detail area will remain in a matte finish as denoted by the (*) in the diagrams below.

A 1" minimum counter thickness is required for edge treatments.

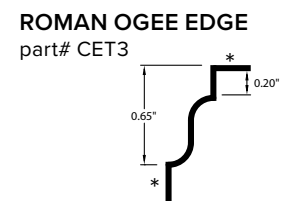
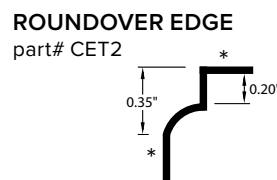
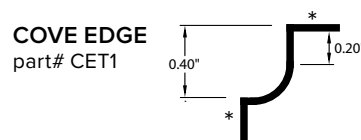

BOUTIQUE COLLECTION Vanity Sinks

VANITY SINK SIZES for SINGLE BOWL			
Length	Finish	Part #	Net Price
24"	Matte	CV-S24MT	\$1,922
	Gloss	CV-S24GL	\$2,108
30"	Matte	CV-S30MT	\$1,990
	Gloss	CV-S30GL	\$2,168
36"	Matte	CV-S36MT	\$2,040
	Gloss	CV-S36GL	\$2,218
42"	Matte	CV-S42MT	\$2,246
	Gloss	CV-S42GL	\$2,472
48"	Matte	CV-S48MT	\$2,300
	Gloss	CV-S48GL	\$2,516
54"	Matte	CV-S54MT	\$2,505
	Gloss	CV-S54GL	\$2,750
60"	Matte	CV-S60MT	\$2,586
	Gloss	CV-S60GL	\$2,843
66"	Matte	CV-S66MT	\$2,834
	Gloss	CV-S66GL	\$3,126
72"	Matte	CV-S72MT	\$2,917
	Gloss	CV-S72GL	\$3,211
AVAILABLE SINGLE SINK BOWL			
Name	Part #	Net Price	
Petra 1	C801S	no charge	
Petra 2	C802S	no charge	
Petra 3	C803S	no charge	
Petra 4	C804S	\$20	
Petra 5	C805S	\$95	
Petra 6	C806S	\$95	
Petra 7	C807S	\$80	
Petra 8	C808S	\$80	
Petra 9	C809S	no charge	
Wymara 1	C821S	\$115	
Wymara 2	C822S	\$150	
Alissa	C841S	no charge	
Halo 1	C861S	no charge	
Halo 2	C863S	no charge	
Luna 1	C864S	no charge	
Luna 2	C865S	no charge	
Incline	C866S	\$150	

Net pricing includes freight, multiplier does not apply.

Prices are based on a deck height of 1/2".
Heights above 1/2" are an upcharge.

VANITY SINK SIZES for DOUBLE BOWL			
Length	Finish	Part #	Net Price
48"	Matte	CV-D48MT	\$2,422
	Gloss	CV-D48GL	\$2,661
54"	Matte	CV-D54MT	\$2,626
	Gloss	CV-D54GL	\$2,895
60"	Matte	CV-D60MT	\$2,738
	Gloss	CV-D60GL	\$3,016
66"	Matte	CV-D66MT	\$2,968
	Gloss	CV-D66GL	\$3,284
72"	Matte	CV-D72MT	\$3,062
	Gloss	CV-D72GL	\$3,378
AVAILABLE DOUBLE SINK BOWL			
Name	Part #	Net Price	
Petra 1	C801D	no charge	
Petra 2	C802D	no charge	
Petra 3	C803D	no charge	
Petra 4	C804D	\$40	
Petra 9	C809D	no charge	
Wymara 1	C821D	\$230	
Alissa	C841D	no charge	
Halo 1	C861D	no charge	
Halo 2	C863D	no charge	
Luna 1	C864D	no charge	
Luna 2	C865D	no charge	
Incline	C866D	\$300	

NOTE:

Vanity sink is available with a single or double bowl and in standard size lengths listed above.

Sink bowl placement is customizable, but overall height and depth are fixed.

Vanity sink has a fixed height and depth depending on the bowl selection. Sink bowl placement is customizable.

See individual worksheet & order form in the MTI binder or mtibaths.com.

Prices listed should be entered next to the appropriate part # on the form.

Submit a signed & completed worksheet with the purchase order.

BOUTIQUE COLLECTION Vanity Options

ADD-ONS & OPTIONS		
Vanity Sink Style	Part #	Net Price
Parsons	CPVS2	no charge
Half-Parsons	CPVS1	\$(150)
Waterfall	CWVS2	\$300
Half Waterfall	CHWVS1	\$150
Intergrated Overflow		
Back installation for single bowl or drain	CIOB	\$75
Back installation for double bowl or drain	CIOB2	\$150
Faucet Holes ◦ up to 3 holes drilled for single drain or 6 for double drains		
up to 6 double drain	CFH	\$25
Backsplash ◦ 4" (h) height x 5/8" thick		
Length up to 50"	CBSM	\$100
Length 51" up to 86"	CBLG	\$135
Sidesplash ◦ 4" (h) height x 5/8" thick		
Left	CSL	\$60
Right	CSR	\$60
Teak Sink Tray		
For toiletries & accessories	CTKST	\$56

DRAIN KITS

DRAIN	FINISH	PART #	PRICE/EA.
Finger Touch Drain ◦ Fully plated brass drain body & tailpiece. Features round flip drain that opens and closes.			
With Overflow	Chrome	CFGC	\$45
	Brushed Nickel	CFGBN	\$50
Without Overflow	Chrome	CFGCN	\$45
	Brushed Nickel	CFGBNN	\$50
Fixed Drain ◦ Dome-style drain for sinks without an overflow. Fully plated brass drain body and tailpiece.			
Without Overflow	Chrome	CFDC	\$80
Grid Drain ◦ Decorative, fully plated, 20-hole brass grid drain. Features 'fast flow angle top', with no clogging or puddling of water.			
With Overflow	Chrome	CGDC	\$30
	Brushed Nickel	CGDCBN	\$45
Without Overflow	Chrome	CGDCN	\$30
	Brushed Nickel	CGDCBNN	\$45

SHELVES

Floating Shelf ◦ choose length & finish. measures 17" (d) x 3" (h) and includes a mounting bracket.			
Length	Finish	Part #	Net Price
24" small	Matte	CFSSMT	\$410
	Gloss	CFSSGL	\$514
30" medium	Matte	CFSMMT	\$461
	Gloss	CFSMGL	\$585
42" large	Matte	CFSLMT	\$514
	Gloss	CFSLGL	\$658
48" x-large	Matte	CFSXLMT	\$565
	Gloss	CFSXLGL	\$721
Waterfall Shelf			
Length	Finish	Part #	Net Price
up to 30" vanities	Matte	CSSSMT	\$410
	Gloss	CSSSGL	\$514
up to 42" vanities	Matte	CSSMMT	\$461
	Gloss	CSSMGL	\$585
up to 54" vanities	Matte	CSSLMT	\$514
	Gloss	CSSLGL	\$658
up to 72" vanities	Matte	CSSXLMT	\$565
	Gloss	CSSXLGL	\$721
Waterfall Shelf ◦ with Teak Insert			
up to 30" vanities	Matte	CTSSMT	\$590
	Gloss	CTSSGL	\$694
up to 42" vanities	Matte	CTSMMT	\$691
	Gloss	CTSMGL	\$815
up to 54" vanities	Matte	CTSLMT	\$789
	Gloss	CTSLGL	\$933
up to 72" vanities	Matte	CTSXLMT	\$840
	Gloss	CTSXLGL	\$996

FLOATING SHELF NOTE:

24" shelf fits beneath Vanity Sink 36" and up.
 30" shelf fits beneath Vanity Sink 42" and up.
 42" shelf fits beneath Vanity Sink 54" and up.
 48" shelf fits beneath Vanity Sink 60" and up.

BOUTIQUE COLLECTION Wall Mounted Vanity Sinks

PETRA WALL MOUNTED VANITY SINK 2 model #VSWM3015 ◦ bowl size: 15" (l) x 11" (d)			
Length	Finish	Part #	Net Price
30" x 15" x 15"	Matte	VSWM3015MT	\$1,127
	Gloss	VSWM3015GL	\$1,259
PETRA WALL MOUNTED VANITY SINK 9 model #VSWM2412 ◦ bowl size: 13" (l) x 8" (d)			
Length	Finish	Part #	Net Price
24" x 12" x 12"	Matte	VSWM2412MT	\$1,076
	Gloss	VSWM2412GL	\$1,208

ADD-ONS & OPTIONS		
Backsplash ◦ 4" (h) height x 5/8" thick		
Length up to 30"	CBSM	\$100
Sidesplash ◦ 4" (h) height x 5/8" thick		
Left	CSL	\$60
Right	CSR	\$60
Textured Front		
Rippled	CTXR	\$60

NOTE:

Faucet can only be mounted on 4" side between sink bowl and edge of vanity.

Bowl can be placed on either left hand or right hand side. Must specify on order.

Includes wall mounting bracket, wall fasteners not included.

Available sizes shown. Custom sizes not available.

See individual worksheet & order form in the MTI binder or mtibaths.com.

Submit a signed & completed worksheet with the purchase order.

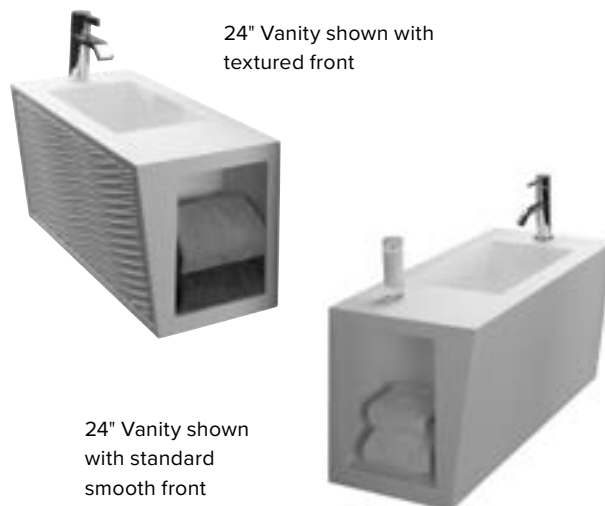

24" Vanity shown with textured front

24" Vanity shown with standard smooth front

BOUTIQUE COLLECTION Pedestal Sinks

PETRA PEDESTAL SINK model #CVP-802 ◦ bowl size: 15.25" x 10.625" x 4.5"			
Length	Finish	Part #	Net Price
19" x 16.5" x 36"	Matte	CVP802MT	\$1,710
	Gloss	CVP802GL	\$1,960
HALO PEDESTAL SINK model #CVP-862 ◦ bowl size: 16.5" x 16.5" x 5.25"			
Length	Finish	Part #	Net Price
28" x 18" x 36"	Matte	CVP862MT	\$1,510
	Gloss	CVP862GL	\$1,760

ADD-ONS & OPTIONS		
Intergrated Overflow		
None	CION	no charge
Front bowl installation	CIOF	\$75
Back bowl installation	CIOB	\$75
Faucet Holes ◦ up to 3 holes drilled for single drain		
None	CFHN	no charge
up to 3	CFH	\$25
Pedestal Options ◦ Sink Bottom Cover-Small		
Matte	CBCSMT	\$173
Gloss	CBCSGL	\$204
Special Color: Enter specific color code from below	CBCCOLG	\$75
	CBCCOLM	\$75
colors: OX = Onyx NF = Nightfall SG = Stormgray MS = Moonstone BL = Blue Lagoon TC = Terracotta		
Drain Kits ◦ see page 9 for options		

BOUTIQUE COLLECTION Countertop

COUNTERTOP SINK			
Length	Finish	Part #	Net Price
up to 38"	Matte	CT-38MT	\$612
	Gloss	CT-38GL	\$775
up to 50"	Matte	CT-50MT	\$947
	Gloss	CT-50GL	\$1,146
up to 62"	Matte	CT-62MT	\$1,049
	Gloss	CT-62GL	\$1,292
up to 74"	Matte	CT-74MT	\$1,172
	Gloss	CT-74GL	\$1,438
up to 86"	Matte	CT-86MT	\$1,422
	Gloss	CT-86GL	\$1,688

COUNTERTOP SINK OPTIONS	PART #	NET PRICE
Deck Height ◦ Standard height is 1/2"		
> 1/2" up to 3"	CDH2	\$120
> 3" up to 6"	CDH3	\$240
Backsplash ◦ 4" (h) height x 5/8" thick		
Length up to 50"	CBSM	\$100
Length 51" up to 86"	CBLG	\$135
Sidesplash ◦ 4" (h) height x 5/8" thick		
Left	CSL	\$60
Right	CSR	\$60
Edge Treatment		
Cove	CET1	\$45
Roundover	CET2	\$45
Roman Ogee	CET3	\$45
Carrier Arms for wall mounting		
Two	CCA2	\$160
Three	CCA3	\$230

BOUTIQUE COLLECTION Benches

BENCHS			
Length	Finish	Part #	Net Price
up to 24"	Matte	CBT-2416MT	\$1,434
	Gloss	CBT-2416GL	\$1,638
up to 30"	Matte	CBT-3016MT	\$1,484
	Gloss	CBT-3016GL	\$1,688
up to 36"	Matte	CBT-3616MT	\$1,580
	Gloss	CBT-3616GL	\$1,784
up to 42"	Matte	CBT-4216MT	\$1,769
	Gloss	CBT-4216GL	\$1,973
up to 48"	Matte	CBT-4816MT	\$1,973
	Gloss	CBT-4816GL	\$2,177

Bench is offered with Parsons-style legs or Waterfall-style sides. Made from SculptureStone™. The top of the bench is available in 3 styles: smooth, with a unique ripple texture, or with a genuine teak inlay. Each bench is 16" (w) x 20" (h) in varying lengths.

NOTE:

Offered in white or biscuit in either matte or gloss. No upcharge on either color.

See individual order form in the MTI binder or mtibaths.com.

Prices listed should be entered next to the appropriate part # on the form.

BENCH OPTIONS	PART #	NET PRICE
Bench Style		
Parsons	CPVS	no charge
Waterfall	CWVS	\$200
Top Options		
Smooth	CTXF	no charge
Rippled Texture	CTXR	\$240
Teak Inlay	CTXT	no charge

Bench with Waterfall design & teak insert.



SMOOTH TOP



RIPPLED TEXTURE



TEAK INLAY

