

AKER Outlook^{plus}™

2013 ADDENDUM PRICE LIST USA UPDATES

UPDATE
JULY 1ST
2013

FULL-STRENGTH bathware line. Engineered for *every stage of life.*

NEW MASSACHUSETTS PARTIAL PACKAGES



- Base model with Massachusetts grab bars
- Base model with Massachusetts grab bars and seat

Model	Package Includes	Dimensions
141381-000-XXX	• Base model • 1 x 48" Horizontal straight textured Stainless Steel grab bar (factory installed)	60 X 36 62 1/2 X 30
141369-000-XXX	• Base model with Massachusetts grab bar & seat package (Meets Massachusetts State code requirements) • 1 x 48" Horizontal straight textured Stainless Steel grab bar (factory installed) • Rectangular fold-up Naugahyde White seat (factory installed)	60 X 36 62 1/2 X 30

REDUCED SKIRT UPDATED INFORMATION

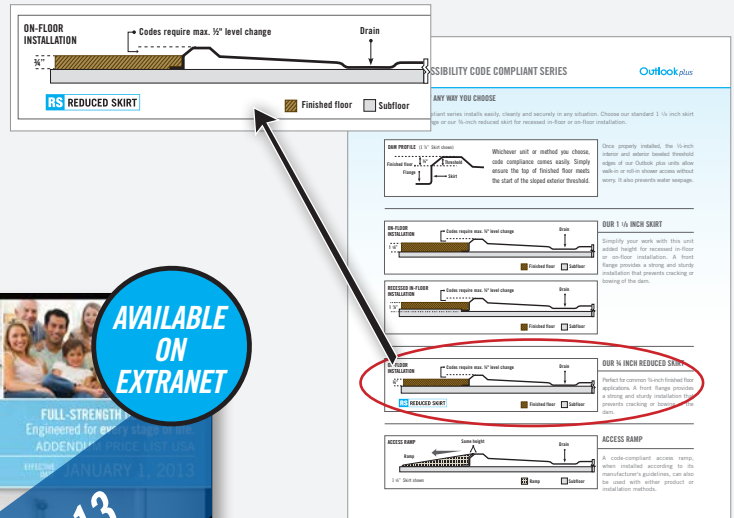

NEW TECHNICAL CONTENT

Updated technical drawings

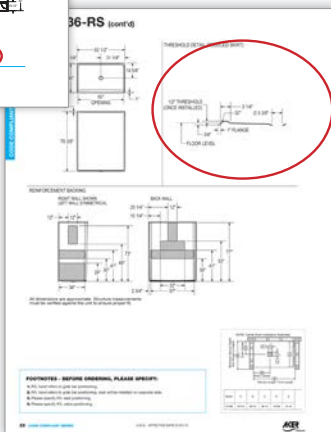
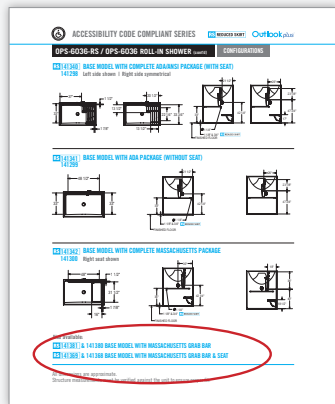

WEB UPDATE

- New Massachusetts models
- Updated Configuration Guide and technical drawings

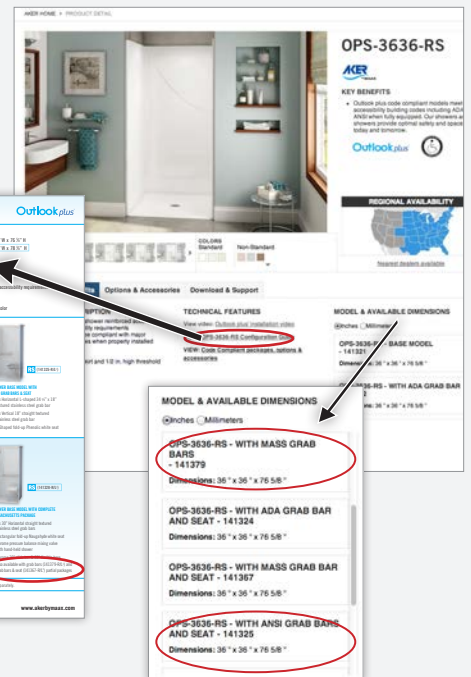
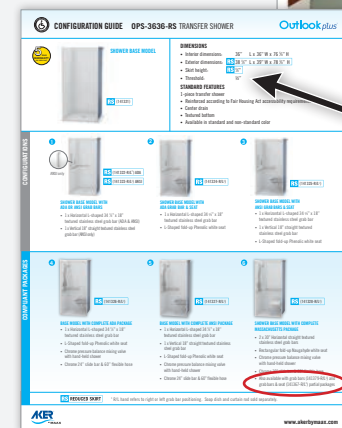

[Click here to download the electronic version](#)

All these features and more to be discovered in this great new tool. Contact your AKER sales representative for more information.

